

SCHEDA TECNICA GIUNTI DI DILATAZIONE CON FLANGE FISSE

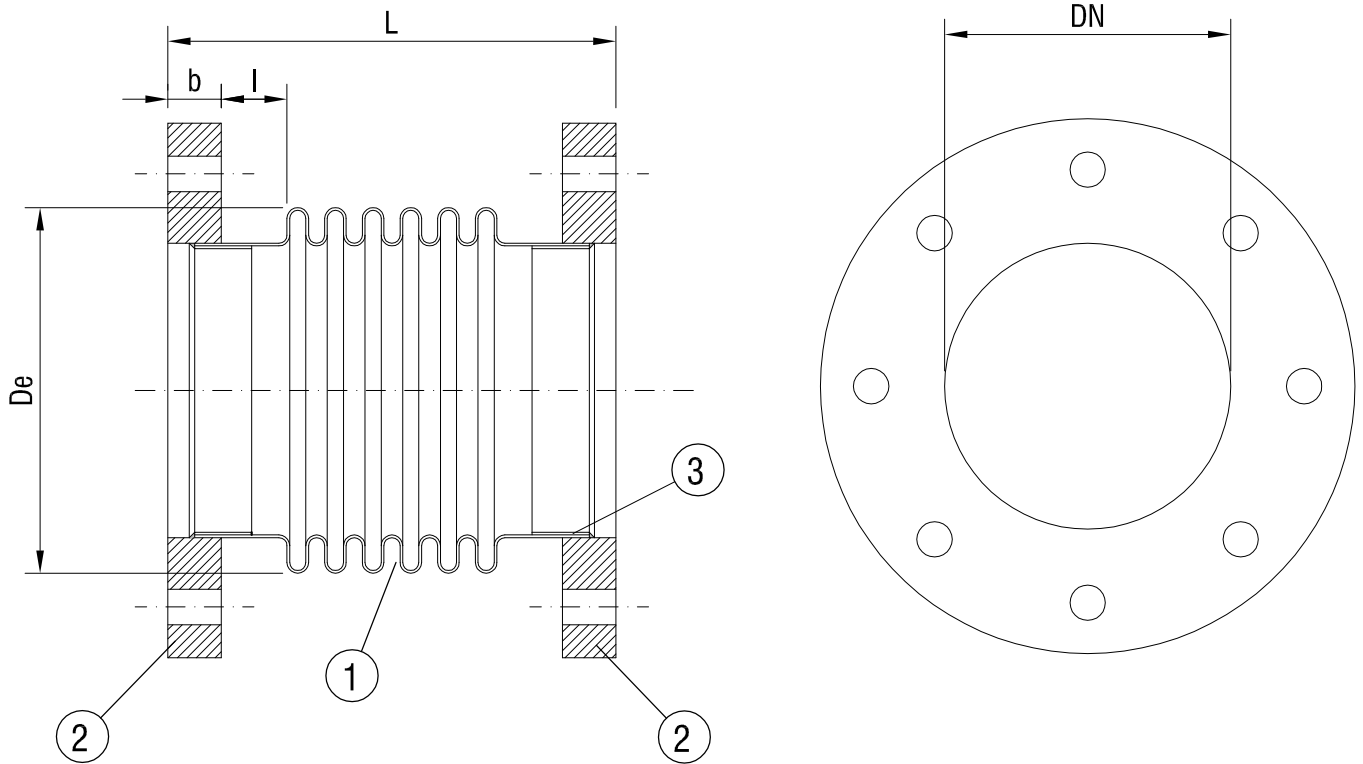

Pos.	Q.ta	DENOMINAZIONE
1	Nr 1	Tubo ondulato INOX AISI321 doppia parete
2	Nr 2	Flangia fissa in acciaio al carbonio
3	Nr 2	Fascetta di rinforzo INOX AISI304

Verniciatura parti in acciaio al carbonio (Flange): vernice RAL 7037 - Temperatura max d'esercizio: 500 C°
 Pressione nominale 2,5 bar - A richiesta pressione nominale 10 bar
 A richiesta con flange INOX in AISI 304 / AISI 316

PRODUCT CODE	NOMINAL COND. (1)				NOMINAL COND. (1)				DESIGN CONDITIONS					SPRING RATE		PRESS. THRUST	Vibr. ampl. (3)	
	PRES.	DIA.	MOVEMENT					FLANGES					NATURAL FREQUENCY		AXIAL			LAT.
			Axial	Lateral				Drill. EN	Plate thk				AXIAL	LAT.				
	PN	DN	± X mm	± Y mm	I mm	L mm	De mm	PN	b mm	P Barg	T °C	Ptest Barg	f _A Hz	f _L Hz	Rx N/mm			Ry N/mm
FL065190DFF+FF	2.5	65	26	12	11	190	98	10	20	1	150	1.5	226.5	386.3	56	38	60	0.72
FL080190DFF+FF	2.5	80	35	18	16	190	115	10	20	1	150	1.5	169.6	356.6	41	43	82	1.08
FL100222DFF+FF	2.5	100	49	22	5	222	142	10	22	1	150	1.5	109.2	204.3	45	37	130	1.32
FL125225DFF+FF	2.5	125	55	20	7	225	171	10	22	1	150	1.5	93	215	41	52	186	1.2
FL150258DFF+FF	2.5	150	61	18	25	258	201	10	24	1	150	1.5	88.2	248.5	42	78	267	1.08
FL200241DFF+FF	2.5	200	58	12	25	241	256	10	24	1	150	1.5	85.6	342.9	33	124	444	0.72
FL250262DFF+FF	2.5	250	71	13	27	262	313	10	26	1	150	1.5	70.4	310	44	38	673	0.78
FL300267DFF+FF	2.5	300	72	11	31	267	366	10	26	1	150	1.5	69.1	363.3	34	218	932	0.66
FL350266DFF+FF	2.5	350	69.5	9.5	29	266	400	10	30	1	150	1.5	71	432.3	36	316	1120	0.57
FL400266DFF+FF	2.5	400	73	9	25	266	452	10	32	1	150	1.5	64.8	434.1	36	378	1442	0.54
FL500283DFF+FF	2.5	500	76	8	21	283	555	10	38	1	150	1.5	58.8	474.2	38	584	2210	0.48